

TURNING STYLES

MUNROE LANE

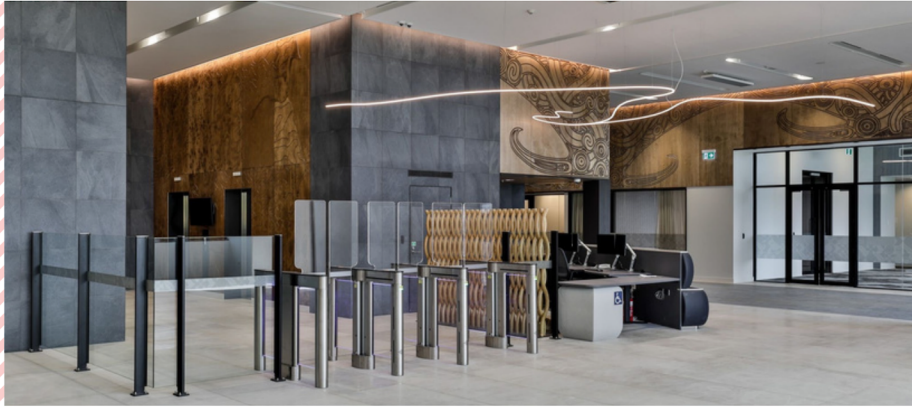

Project Description

Custom Technology Systems supplied and installed Alvarado SU5000 Optical Turnstiles for the new Auckland Council building located in the north of the city.

System Solution

One set of Alvarado SU5000 Optical Turnstiles 3Lane Combo. Consisting of two standard passage width and one disability accessible width.

ARA Security, our long-term expert partner integrated Gallagher Command Center to the Speedgates for employee Access Control.

Bi-Directional Swing Barriers open for staff when they present their valid access control credential, in this case being their staff identification card.

Customisation and Design

Full-Height Bi-Directional Acrylic Swinging Barriers.

Stainless Steel Cabinets.

Dynamic Blue Side Panel LED Lighting provides both interior design features, and also way-finding and security benefits.

Upon a receipt of authorisation, the lighting becomes "green" to identify that access is granted.

Alarm conditions such as unauthorised entry, tailgating, loitering ect, changes the lighting to "red" to visually notify staff.

Located in the cities northern corridor, 6-8 Munroe Lane is designed around a modern workforce. With high-end facilities to allow employees the flexibility to live work and commute the way they desire.

The 6 Level, 15, 900sqm achieved a 5-star Green Star Built rating a 5-star NABERS rating.

Custom Technology Systems worked together with the key tenant and their security contractor during the design phase to supply a solution for the new office building.

One set of Alvarado's 3Lane SU5000 Optical Turnstile located in the lift lobby to manage and control the building entry access for employees were installed.

